

L624-  
A.05.16

**To:** Official After Sales Network  
**Subject:** Haldex control unit cover.  
**Date:** March 18,2016  
**Pages:** 2



**Subject.**  
Haldex control unit cover.

**Model.**  
Huracàn Coupè

**Model year.**  
2015 .

**Special or Limited Versions.**  
All versions.

**Markets.**  
All.

**VIN identification**  
 From **FLA00163 to FLA04027**

**Warning:** some vehicles included in this VIN range may not be involved, so check carefully on the Lamborghini WEB Portal (at the section named VIN Info) if the cars in your workshop or in your dealer stock are involved before performing any other operation.

**Information to the field.**

As a result of continuous product monitoring, Automobili Lamborghini Spa has found that the cover which shields the Haldex Control unit from humidity is missing on some cars.

**Field solution.**

Update the car following the herein reported instructions.

**Spare parts.**

P/N	Description	Q
4T0498001	Haldex control unit cover. It includes Cover Q1 Fastener Q1	1

**Replaced parts management.**

Store properly and tagged the parts replaced with bar code form for their identification during Area Manager visits.

**Bulletin substitution**

None.

**Warranty Claim data.**

The warranty reimbursement request for this rework action will be managed by the following standard Warranty Claim procedures.

**Campaign Code:** L624-A.05.16  
**Campaign Des.:** Haldex control unit cover.  
**Cost code:** 50  
**Component code:** CCA0516

**Trouble code:** 220  
**Labor code:** CCA0516100  
**Labor Time:** 0,8 h

Remember to fill all data in the section “Service and Recall Campaign” in the Warranty booklet of the vehicle as shown below.

**Necessary tools/material.**

P/N	Description	Q
-	-	-

Rev.01

The information and procedures published below are strictly confidential and intended exclusively for authorized operators and individuals. All copyrights are the property of Automobili Lamborghini S.p.A based on copyright law. The company reserves the right to make updates and modifications. The reprinting, reproduction, forwarding to unauthorized people and/or to third parties and partial or entire translation thereof are prohibited without written authorization from Automobili Lamborghini S.p.A.

doc. nr: L/V6\_M06 Rev.[02]

1/2



**Preliminary operations:**



**Warning!**



Operation to be performed at cold engine.

1. Secure the vehicle by engaging the parking brake.
2. Luggage compartment disassembling.

Disassemble the luggage compartment following the instructions reported at the Chapter 08, paragraph 63 from the workshop manual related to the subject vehicle market.

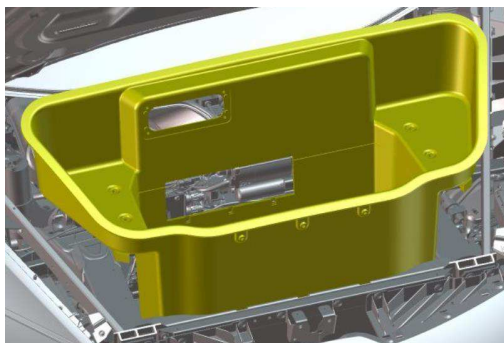

3. Haldex control unit fixing elements removal.

Remove the screws which secure the Haldex control unit.



**Notes.**

Screw tightening;  
torque: **30Nm**



**Cover installation:**

4. Fit the cover with the clip as shown below.



5. Install the cover on the Haldex control unit and check the clip is correctly embedded.



6. Final Steps.

Restore the vehicle following the instructions in reverse order from step 3.